

## LOCATION

Building A  
714 NE 55th Avenue  
Portland, OR 97213

## TOTAL SQ. FT. OFFICE SQ. FT.

31,215 sq.ft. (Divisible)  
2,615 sq.ft.

## DOCK DOORS DRIVE-IN DOORS CLEAR HEIGHT

4  
2  
16'

## FEATURES

- Close-in Industrial
- Light Rail located within 1 block
- Available mid-2024

## LEASE RATE

\$0.85/sq.ft., Shell  
\$1.00/sq.ft., Office  
NNN

## LEASING CONTACTS

**SAM BRIGGS**  
samb@pactrust.com  
503.624.6300

**JAKE BIGBY**  
jakeb@pactrust.com  
503.624.6300

**CAITLIN KNECHT**  
caitlink@pactrust.com  
503.624.6300



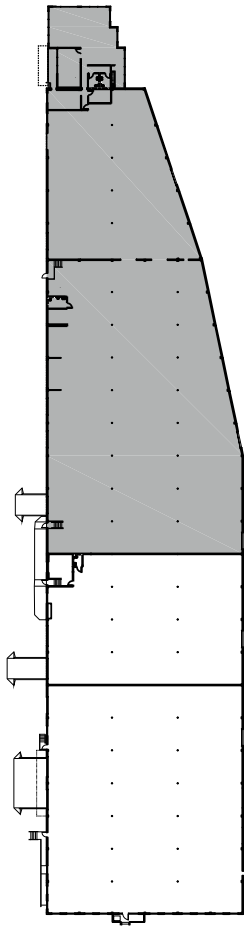

**TOTAL 31,215 SQ FT - DIVISIBLE**  
**OFFICE 2,615 SQ FT**  
**CLEAR HEIGHT 16'-0" FT**

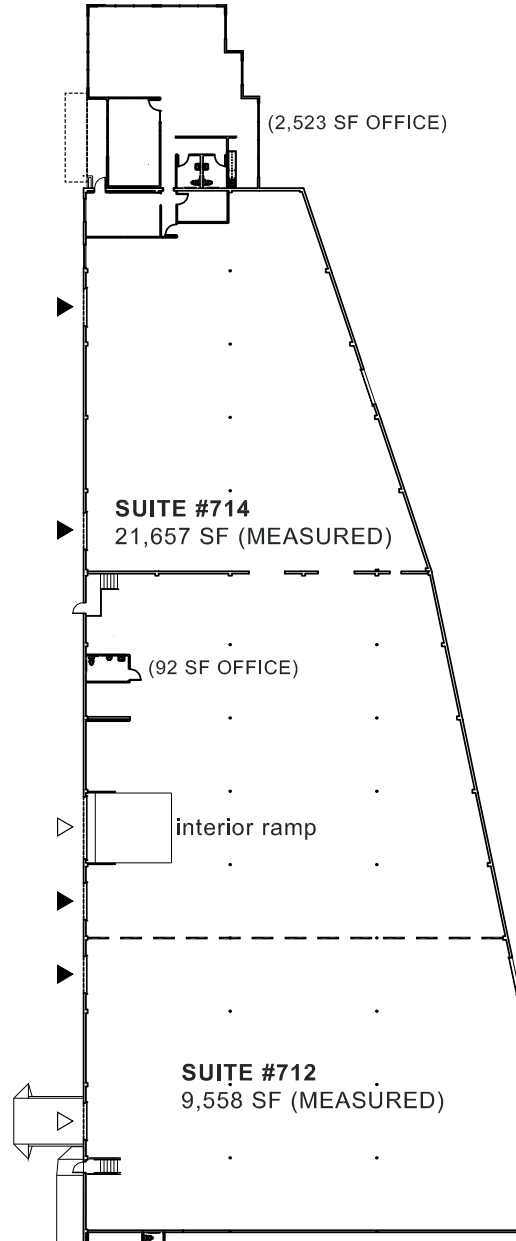
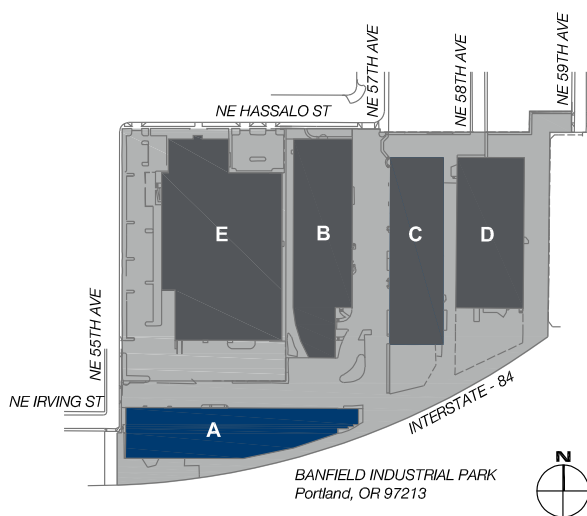

**BUILDING PLAN** 



-  **GRADE ACCESS**
-  **DOCK ACCESS**

15350 SW Sequoia Pkwy Suite 300 Portland OR 97224 • 503.624.6300 • [pactrust.com](http://pactrust.com)

The square footage and rates quoted herein are subject to change. Square footage and rates are finalized with a signed lease agreement.

