

# Cabin Branch Distribution Center

1501-1595 Cabin Branch Road  
Landover MD 20785

## PROPERTY DESCRIPTION

Cabin Branch Distribution Center is a 1,035,764 square foot distribution/industrial center situated on 49.90 acres in the Landover area of Prince George's County, Maryland. The property is within the Beltway (I-495) and less than one mile from Highway 50.

The project consists of 577,750 square feet of rehabilitated warehouse and office, a 27,939 square foot former truck repair facility and 430,000 square feet of new industrial/distribution buildings.



## MANAGEMENT CONTACT

Jason Soistman—[jsoistman@naimichael.com](mailto:jsoistman@naimichael.com)  
NAI Michael Companies  
301.918.2947

## LEASING CONTACT

Scott Hodson—[scotth@pactrust.com](mailto:scotth@pactrust.com)  
PacTrust  
503.624.6300



## HIGHLIGHTS

- ⌘ Industrial/warehouse
- ⌘ 1,035,764 rentable square feet
- ⌘ Adjacent to the Columbia Park Interchange on Route 50 with desirable routes to and from the District; one mile to the Cheverly Metro Station
- ⌘ Enterprise zone benefits and incentives available to tenants



# Cabin Branch Distribution Center

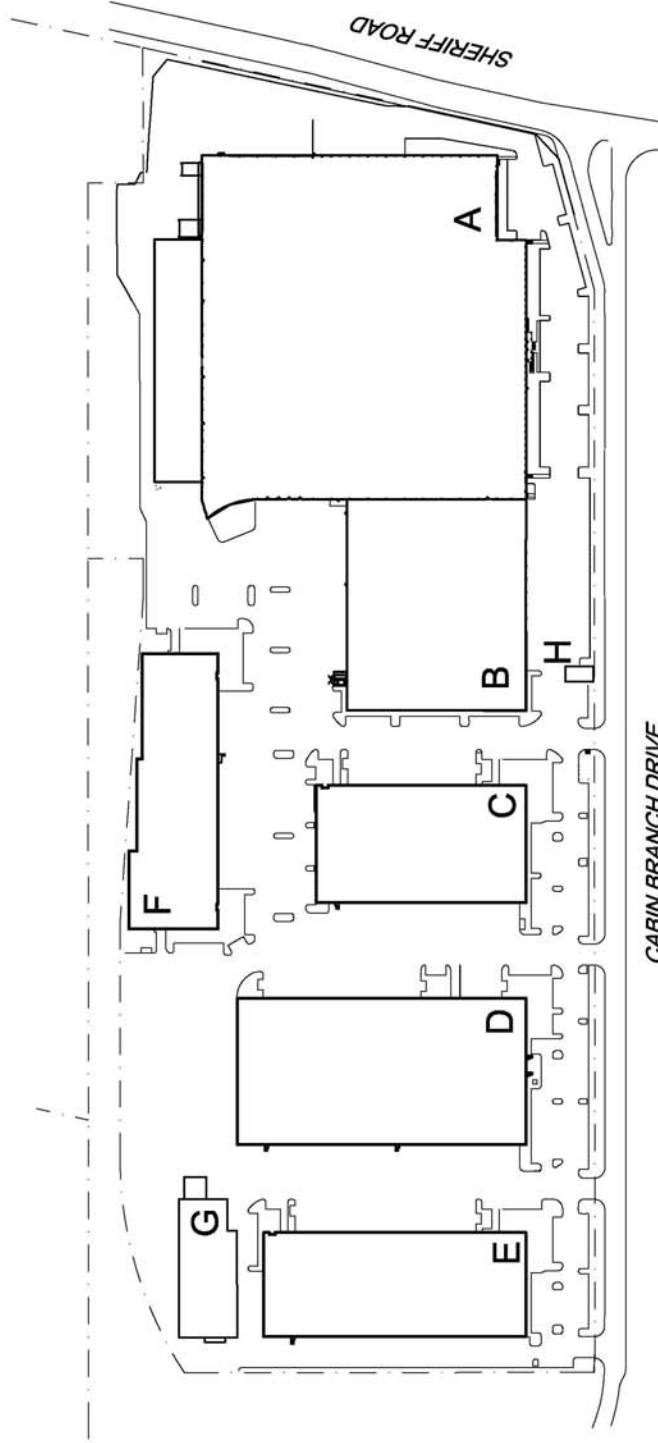

**CABIN BRANCH  
DISTRIBUTION CENTER**  
CABIN BRANCH DRIVE  
LANDOVER, MARYLAND 20785



**A FACTRUST PROPERTY**